

PANDJIRIS,[®] INC.

#1 in Hard Welding Automation

PIPP PARTNERS IN
PROFITS &
PROGRESS

PRODUCT BULLETIN FOR LINCOLN PARTNERS

JANUARY 2006

FULLY INTEGRATED HEAVY DUTY MANIPULATOR SYSTEM WITH POWER WAVE AC/DC SAW FOR WELDING STAINLESS STEEL TANKS

The Lincoln Electric-Pandjiris Partnership creates consumable orders for Lincoln when teamed with Pandjiris fixed automated equipment and welding solutions. The sales and technical organizations of both companies are coordinating to bring to the end user the most advanced integrated turnkey systems in the welding industry. Faced with strong challenges for technical innovation, more productivity, and cost control improvements, The Lincoln Electric-Pandjiris Team is successfully bringing new value-added automation solutions to the market place.

As another example, representatives of both Lincoln Electric and Pandjiris joined forces and successfully met and exceeded a large stainless steel tank manufacturer's expectations. This stainless steel fabricator needed to perform longitudinal welds on stainless steel tanks up to 11'-0" in diameter utilizing the best and latest submerged arc technology in their stainless steel welding operations. The customer wanted the best technical and integration expertise along with improved productivity and cost improvements. The Lincoln Electric-Pandjiris Team met all these requirements successfully.

Pandjiris Series 1400 Welding Head Manipulator, SW-180 swivel, and motorized cross slides for precise torch placement integrated and tested with Lincoln's Power Wave AC/DC submerged arc welding package and technology, produced yet another success story. The customer was trained by Lincoln's and Pandjiris' technicians both in the operation of the Power Wave controls and the operation of the complete Automated Manipulator System.

Lincoln Electric and Pandjiris can offer fabricators all over the U.S. and the world fully integrated turnkey systems to enhance productivity, quality, operating efficiency, and profitability. This fully integrated turnkey manipulator system can be duplicated in any steel tank fabricator plant or application. Call Pandjiris for a system to meet your customer's application.



SERIES 1400 MANIPULATOR WITH POWER WAVE SUBMERGED ARC PACKAGE

14' Boom Stroke at variable Speed
 Maximum 14' Under boom Vertical Stroke
 Manual Column Rotation
 Free Standing Base
 Support Platform for Welding Power Source, Flux
 Recovery and Power Distribution
 Model SW-180 Swivel
 Model 61-P Motorized 6" Stroke Cross Slides
 Power Wave Ad/DC-1000 Power Source
 Power Feed 10A Controller and Power Feed 10S Head
 Contact Nozzle Assembly

Features

Heavy Duty Box Beam Construction
 Remote Pendant with Joystick Controls
 Precisely-Machined Anti-Fall Device
 360 Degree Rotation
 Rack and Pinion Drive System for Boom Movement
 Precision Machined Ways

Benefits

Consistent Quality
 Increased Productivity
 Cost Savings

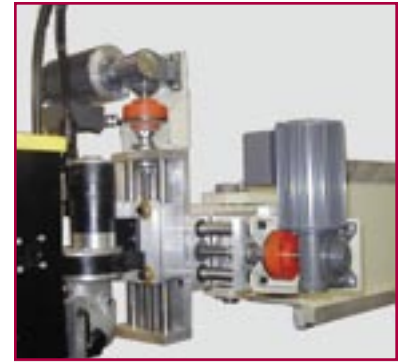

Compound 61-P Slides



SW-180 Swivel with Slides



SW-180 Swivel

Pandjiris SW-180 Swivel is ideal for mounting all welding head apparatus. It swings at +90°, 0°, -90° about a vertical axis. It allows orientation of the welding torch, flux pick-up and seamtracker probes without disassembly or remounting. The SW-180 is ideal for side beam carriages or manipulators to allow both circumferential and longitudinal welds.

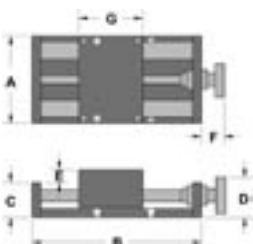

Manual Slides

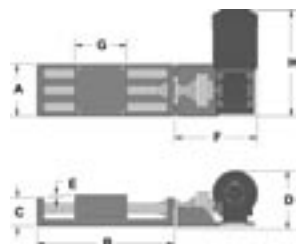

Power Slides

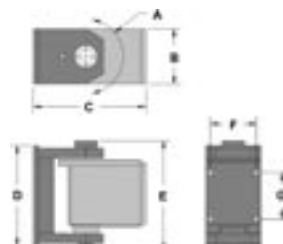

SW-180 Swivel

Model	Load Capacity	Ship Weight (lbs)	A	B	C	D	E	F	G	H
21-M / 61-M	200 lbs @ 6"	18/34	55	8-1/2 Plus Stroke	3	4	0.3125	3.5	5.5	-
21-P / 61-P	200 lbs. @ 6"	22/38	55	8-1/2 Plus Stroke	3	6.25	0.3125	8.88	5.5	10.19
615M	500 lbs. @ 12"	164	10	13-9/16 Plus Stroke	3.5	4.5	1.06	3.5	10	
615P	500 lbs. @ 12"	184	10	13-9/16 Plus Stroke	3.5	6.19	1.06	8.75	10	12.44
SW-180	-	60	180	5.5	11.25	10	10.5	4.625	4.625	