

PANDJIRIS, INC

5151 Northrup • St. Louis, MO 63110 • (314) 776-6893

SUPER PIPER 10/5 TURNING ROLL

The **Model Super Piper 10/5 Power Roll** has a capacity of 10,000 lbs. turning and 5,000 lbs. weight capacity, steel wheels with positive gear drive. An electronic variable speed drive allows a welding speed of 9 to 180 IPM with a field changeable plug-in hand pendant. This includes "Forward-Stop-Reverse-Weld/Rapid" buttons and a speed adjustment potentiometer on 25' of cable to handle workpieces from 10" to 48" diameter. The standard electricals are 115 volts, single phase, 60 cycle, draws 6.5 amps. Wired to conform to the National Electrical Code Standards.

- Turning Capacity 10,000 lbs.
- Tractive Effort 312 lbs
- Load Capacity. 5,000 lbs.
- Pipe Diameter Range 10" thru 48"
- Speed Range 9 to 180 ipm
- Motor Horse Power Rating 1/3 HP
- Wheel Diameter 12" (Steel Wheel)
- Combined Wheel Face 1-7/8"

The **SI/5 Idler Roll** has 5,000 lbs. support capacity.

- Weight Capacity of SI/5 Idler Roll 5,000 lbs
- Weight Capacity of (1) SP/10 Power Roll with (1) SI/5 Idler Roll 10,000 lbs

POWER ROLL		
A	Wheel Height	15"
B	Wheel Diameter	12"
C	Wheel Face	1-7/8"
D	Pipe Diameter Range	10" - 48"
E	Frame Length	39"
F	Frame Width	17"

IDLER ROLL		
H	Wheel Height	15"
I	Wheel Diameter	12"
J	Wheel Face	2"
K	Pipe Diameter Range	10" - 48"
L	Frame Length	32"
M	Frame Width	6"

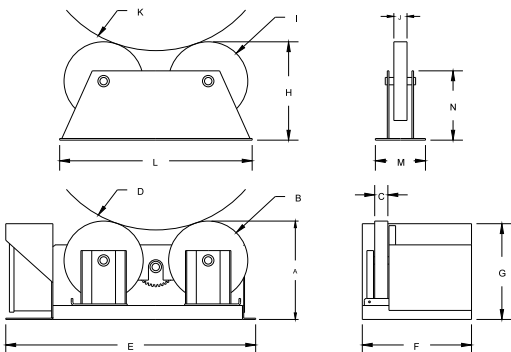

Terms: Pandjiris, Inc. standard terms and conditions apply, f.o.b. Factory, St. Louis, Missouri, or designated ship point.

Delivery: Consult Factory
 Approximate shipping weight:
 Power Roll 450 lbs.
 Idler Roll 250 lbs.

PRICE LIST	
For Bulletin No.	: PW-4073
Effective Date	: April 1, 1998
Page Number	: C-5

PANDJIRIS, INC

5151 Northrup • St. Louis, MO 63110 • (314) 776-6893

SUPER PIPER TURNING ROLL Optional Accessories

For foot switch with compatible plug for Forward/Stop/Reverse
(speed potentiometer on hand pendant)

For foot switch, Fast-Slow with compatible plug

For preset digital tachometer with compatible plug reads
speed in IPM or CmPM

Hold-down for 3-1/2" to 36" diameters

For less than 10" dia. workpiece, SP/10-3.5 steel wheel adapter to power unit

For less than 10" dia. workpiece, SI/5-3.5 steel wheel adapter to idler

For 25' Extension Cable with compatible plugs for standard
pendants and accessories

For special voltages

PRICE LIST

For Bulletin No. : 51566-A/493
Effective Date : July 1, 2000
Page Number : C-6