

PANDJIRIS, INC

5151 Northrup • St. Louis, MO 63110 • (314) 776-6893

DOUBLE 8 MANIPULATOR

The **Double 8 Manipulator, size 8 x 8**, is mounted on a bolt-down base. It has an 8' nominal arc height and an 8' horizontal boom stroke at a variable speed of 3" to 110" per minute. This is electronically controlled with dynamic braking beginning 21" from the centerline of the column and 360-degree manual column rotation. The standard electricals are 230/460 volts, 3 phase, 8/4 Amps, 50/60 Hz with 24-volt controls. A fused disconnect is included and is interlocked with the door. Wired to conform to National Electrical Code Standards.

Vertical Boom Travel20-5/8" Minimum, 112" Maximum, Floor to Bottom of Boom.

Hoist Speed.....73 IPM Constant Speed

Hoist Motor.....½ H.P. AC Brakemotor

Horizontal Boom Stroke8' Stroke beginning 21" From Center of Column

Horizontal Boom Speed3 to 110 IPM Variable Speed

Horizontal Boom Motor.....1/3 H.P. DC Motor

Anti-Fall Device Spring loaded; self-energizing pawl mounted on the crosshead engages column face.

Column Rotation Manual 360-degree rotation with a manually operated screw friction lock.

Bolt Down Base..... Size 15" x 15", with (4) 13/16" Drilled holes on 13" square.

Control Pendant control equipped with joystick for Boom "Up-Down-In-Out".

10-Turn Boom Speed Potentiometer and a Weld-Rapid Selector Switch. Pendant controls operate on 24 volts on 35' of rubber covered cable.

Electrical 230/460 Volts, 8/4 Amps, 50/60 Hz

The following price is for the basic manipulator, including all motors and controls, wired and ready to operate. Price does not include any welding heads, welding controls power source, flux recovery systems, or interconnecting cables, nor does it include the mounting or wiring of these items.

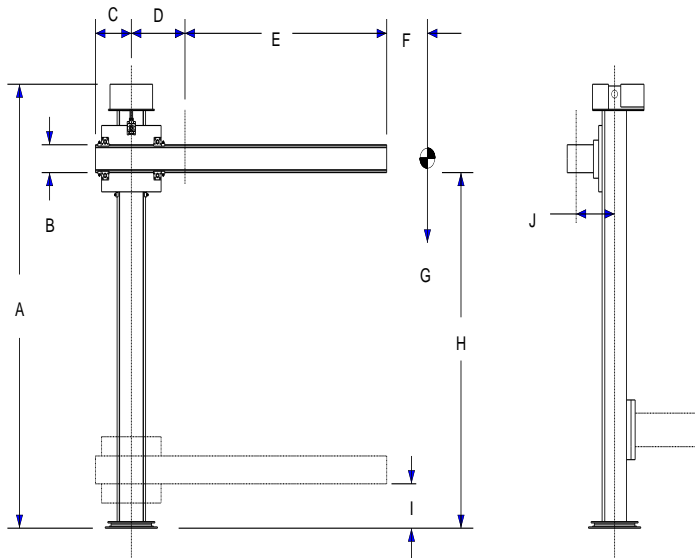

A	Overall Height	11' 10-3/4"
B	Boom Track Blade	7"
C	Min. Rear Clearance	12-5/8"
D	Boom Retract	21"
E	Boom Stroke	8"
F	C.G. Distance	18"
G	Max. Load End/Total	300/500
H	Max. Boom Height	112"
I	Min. Boom Height	20-5/8"
J	Boom Centerline Offset	7-7/16"

Terms: Pandjiris, Inc. standard terms and conditions apply, f.o.b. Factory, St. Louis, Missouri, or designated ship point.

Delivery: Consult Factory

Shipping weight, 1,200 lbs.

PRICE LIST

Effective Date : January 2014
Page Number : D-5

PANDJIRIS, INC

5151 Northrup • St. Louis, MO 63110 • (314) 776-6893

SERIES 800 MANIPULATOR Options and Accessories

For column or boom addition, add per foot

For column or boom deletion N/C

For free standing base

For Power Cable Track for Column and Boom (For sizes other than 8x8, Consult Factory)

Preset digital tachometer in manipulator joystick hand pendant, reads in IPM or CmPM, for boom

For variable speed hoist, 3 to 73 IPM

For "Step-Over" control, allows indexing of boom movement for overlay operations etc.

For flashing red light at column top and boom end with audible alarm

For special voltages, add Consult Factory

For 1-1/2 H.P. Flux recovery unit - installed (including hose), add Consult Factory

For 3 H.P. Flux recovery unit - installed (including hose), add Consult Factory

For 5 H.P. Flux recovery unit - installed (including hose), add Consult Factory

For 7-1/2 H.P. Flux recovery unit - installed (including hose), add Consult Factory

WELD EQUIPMENT MOUNTING CHARGES

Pandjiris will mount and integrate welding head and control packages on the above manipulator. The configuration of the mounting will typically include installation of the wire drive, torch wire reel, flux hopper, wire drive control, and connection of all cables and hoses between the power source and wire feed control required for proper operation. Other accessories such as AVCs, slides, swivels etc. can also be mounted for an extra charge.

To Mount a Single Wire SUB-ARC package

To Mount a Twin Wire SUB-ARC package

To Mount a MIG package

To Mount a Cold Wire TIG package

To Mount a Fusion TIG package

To Mount an AVC with the above TIG packages

To Mount a dual axis seam tracker

To mount wire reel at aft end of boom with insulated wire guide conduit running the length of the boom, add per foot of boom stroke

Terms: Pandjiris, Inc. standard terms and conditions apply, f.o.b. Factory, St. Louis, Missouri, or designated ship point.

Delivery: Consult Factory

PRICE LIST

Effective Date : January 2014
Page Number : D-6